

# MUEBLE CITY-MIX & MATCH

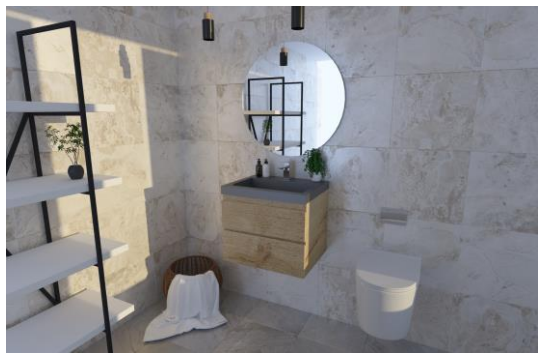

## COLORES DISPONIBLE BASES



MAPLE GREY  
(ENCHAPADO)



IRONWOOD  
(ENCHAPADO)



NUTWOOD  
(ENCHAPADO)



THUNDER GREY  
MATT  
(LACADO)



HIGH GREY GLOSSY  
(LACADO)

## COLORES DISPONIBLE CUBIERTAS



BLACK MATT



CEMENT

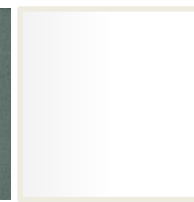

BLANCO

**DESCRIPCION**  
 Muebles de baño  
 Modelo: CITY  
 Medidas Disponibles: 600-700-800-900-1000-1100-1200 mm  
 Material del mueble: MFC  
 Terminación: enchapado o lacado  
 Espesor: 18 mm  
 Cubierta: Polvo de mármol con resina (blanca, negra y gris)  
 Con rebalse  
 2 cajones con cierre soft Close  
 Resistencia en peso cajón: 30 kg  
 Diseño con corte a 45°  
 No Incluye Grifería  
 Instalación: Suspendida (fijaciones incluidas)  
 Mueble armado  
 Sistema Fast Installation: Solo 1 persona requerida

**COMPLEMENTOS**  
 Grifería sin desagüe automático



## DETALLE TECNICO

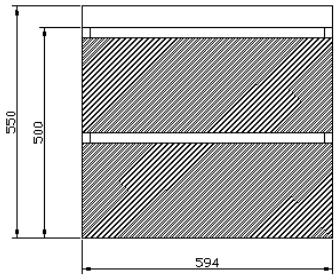
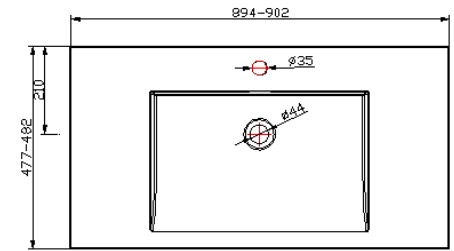
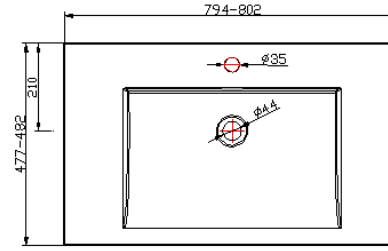
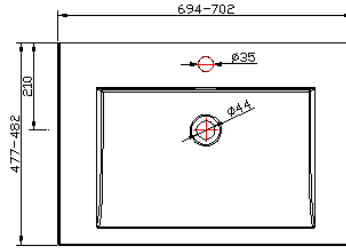
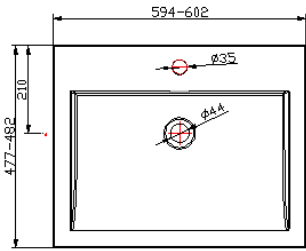

MUEBLE CITY 600

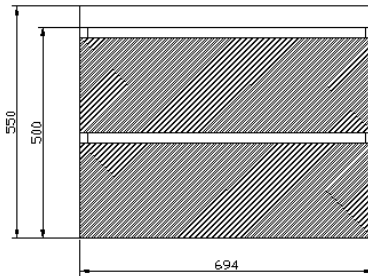

MUEBLE CITY 700

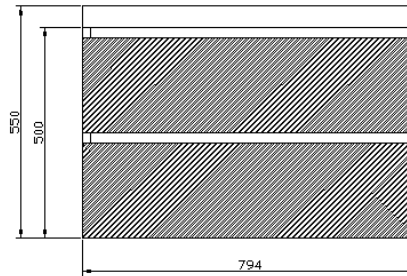

MUEBLE CITY 800

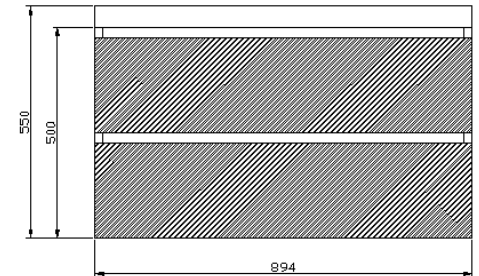

MUEBLE CITY 900

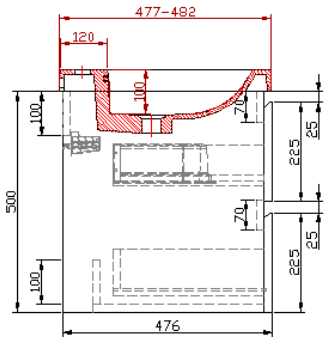

## DETALLE TECNICO

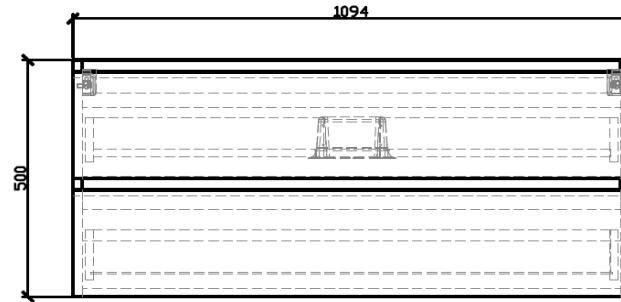
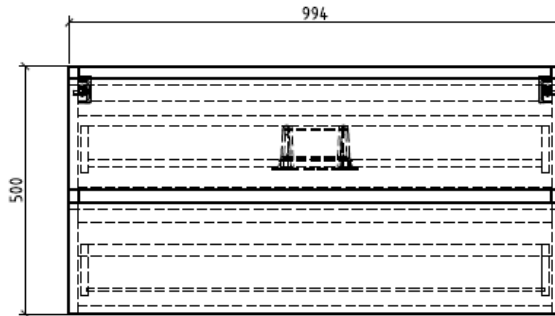
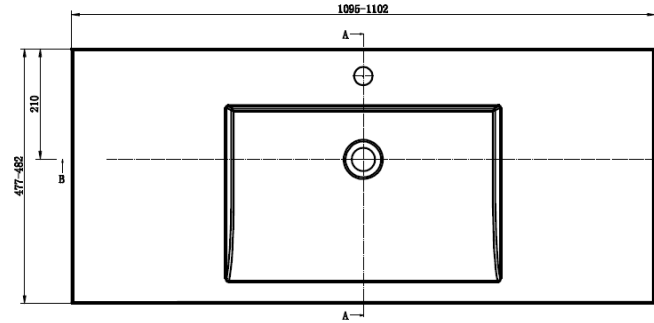
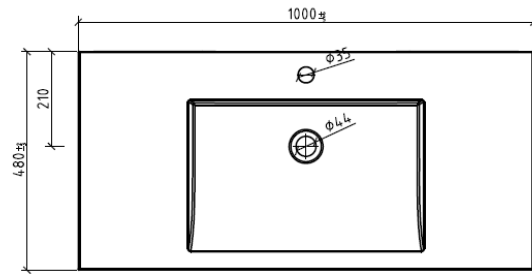

MUEBLE CITY 1000

MUEBLE CITY 1100

## DETALLE TECNICO

MUEBLE CITY 1200

